

# ALLEN CABEZA FREZADA CALIDAD 12.9 MÉTRICO

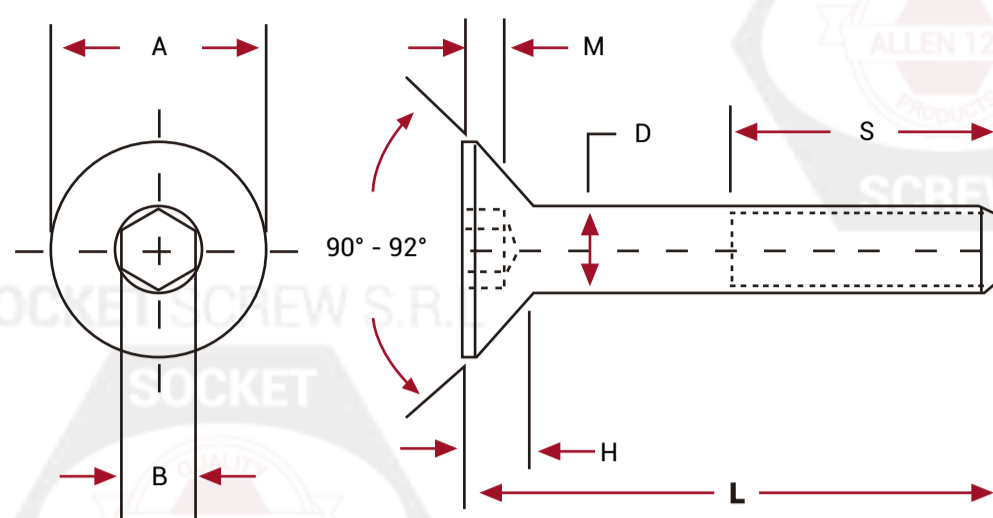

Flushness Gauge

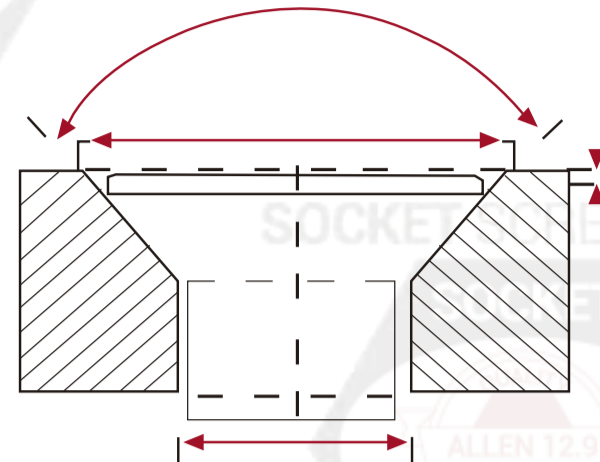

## Dimensiones (mm)

Nom. Size	A	D	B	M min.	S min.	H max.	Da max.	F max.	RS Torque (NM)	
									12.9	10.9
M3	5.54 - 6.72	2.86 - 3.00	2.020 - 2.080	1.10	18	1.86	3.30	0.25	1.35	1.15
M4	7.53 - 8.96	3.82 - 4.00	2.520 - 2.580	1.50	20	2.48	4.40	0.25	3.10	2.70
M5	9.43 - 11.20	4.82 - 5.00	3.020 - 3.080	1.90	22	3.10	5.50	0.30	6.10	5.40
M6	11.34 - 13.44	5.82 - 6.00	4.020 - 4.095	2.20	24	3.72	6.60	0.35	10.5	9.15
M8	15.24 - 17.92	7.78 - 8.00	5.020 - 5.140	3.00	28	4.96	8.54	0.40	26.0	22.0
M10	19.22 - 22.40	9.78 - 10.00	6.020 - 6.140	3.60	32	6.20	10.62	0.40	52.0	44.0
M12	23.12 - 26.88	11.73 - 12.00	8.025 - 8.175	4.30	36	7.44	13.50	0.45	90.0	77.0
M14	26.52 - 30.80	13.73 - 14.00	10.025 - 10.175	4.50	40	8.40	15.50	0.50	143	122
M16	29.01 - 33.60	15.73 - 16.00	10.025 - 10.175	4.80	44	8.80	17.50	0.60	225	190
M20	36.05 - 40.32	19.67 - 20.00	12.032 - 12.212	5.60	52	10.16	22.00	0.75	440	371

## Mechanical Properties

Property Class	12.9
Hardness (HRC)	39 - 44
Tensile Strength (Mpa)	980 min
Descarburization and Carburization	E=3/1 H1

## Typical Application Fixture

Flat socket head cap screws are designed for use in applications where the head cannot protrude above the mating parts. They are set in countersunk holes and the top of the head is flush with the surface of the assembly.

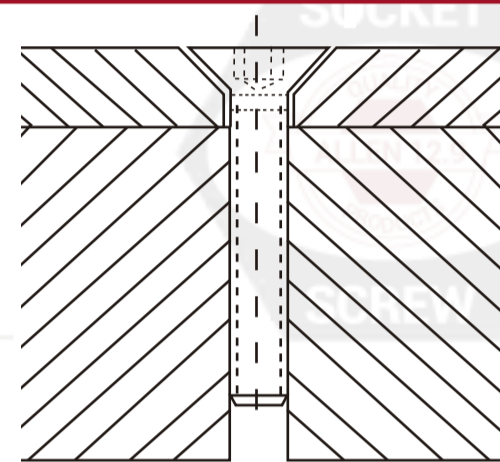

# ALLEN CABEZA FREZADA CALIDAD 12.9 PULGADA

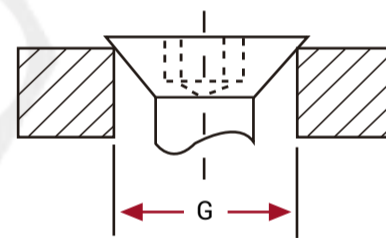
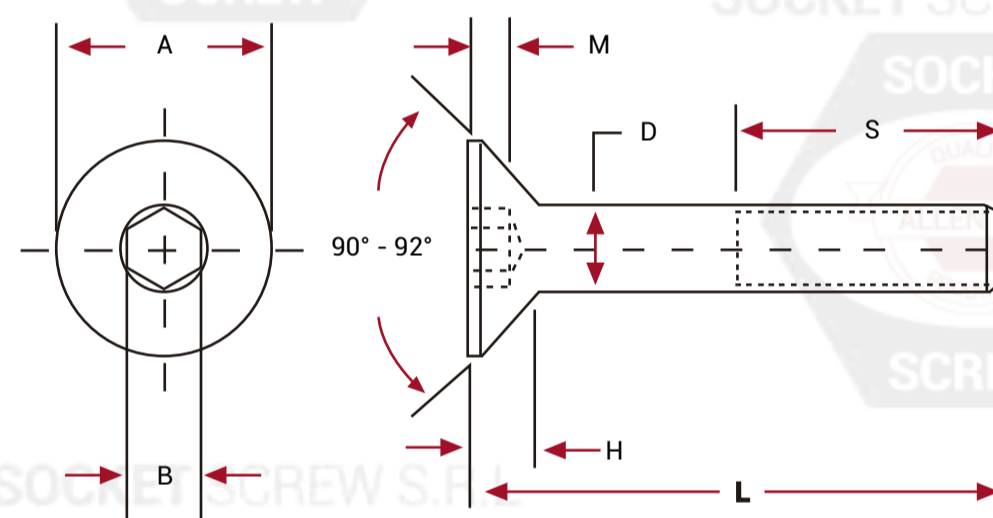

## Dimensiones (inch)

Nom. Size	A	D	B nom.	M min.	G
#0	0.117 - 0.138	0.0568 - 0.600	0.035	0.025	0.077 - 0.078
#1	0.143 - 0.168	0.0695 - 0.0730	0.050	0.031	0.100 - 0.101
#2	0.168 - 0.197	0.0822 - 0.0860	0.050	0.038	0.123 - 0.124
#3	0.193 - 0.226	0.0949 - 0.0990	1/6	0.044	0.147 - 0.148
#4	0.218 - 0.255	0.1075 - 0.1120	1/16	0.055	0.171 - 0.172
#5	0.240 - 0.281	0.1202 - 0.1250	5/64	0.061	0.195 - 0.196
#6	0.263 - 0.307	0.1329 - 0.1380	5/64	0.066	0.219 - 0.220
#8	0.311 - 0.359	0.1585 - 0.1640	3/32	0.094	0.266 - 0.267
#10	0.359 - 0.411	0.1840 - 0.1900	1/8	0.125	0.312 - 0.313
1/4	0.480 - 0.531	0.2435 - 0.2500	5/32	0.156	0.423 - 0.424
5/16	0.600 - 0.656	0.3053 - 0.3125	3/16	0.188	0.538 - 0.539
3/8	0.720 - 0.781	0.3678 - 0.3750	7/32	0.219	0.652 - 0.653
7/16	0.781 - 0.844	0.4294 - 0.4375	1/4	0.250	0.689 - 0.690
1/2	0.872 - 0.938	0.4919 - 0.5000	5/16	0.312	0.738 - 0.739
5/8	1.112 - 1.188	0.6163 - 0.6250	3/8	0.375	0.961 - 0.962
3/4	1.355 - 1.438	0.7406 - 0.7500	1/2	0.500	1.185 - 1.186
7/8	1.604 - 1.688	0.8647 - 0.8750	9/16	0.562	1.410 - 1.411
1"	1.841 - 1.938	0.9686 - 1.0000	5/8	0.625	1.634 - 1.635
1-1/8	2.079 - 2.188	1.1086 - 1.2500	3/4	0.750	1.858 - 1.859
1-1/4	2.316 - 2.438	1.2336 - 1.2500	7/8	0.875	2.082 - 2.083
1-3/8	2.553 - 2.688	1.3568 - 1.3750	7/8	0.875	2.305 - 2.306
1-1/2	2.791 - 2.938	1.4818 - 1.5000	1"	1.000	2.529 - 2.530

## Dimensiones (inch)

Nom. Size	P	S min	R.S Torque (in 1b)
#0	0.026 - 0.036	0.50	1.42
#1	0.028 - 0.040	0.62	252
#2	0.031 - 0.043	0.62	4.18
#3	0.033 - 0.046	0.62	6.33
#4	0.036 - 0.049	0.75	8.88
#5	0.037 - 0.051	0.75	13.1
#6	0.037 - 0.052	0.75	16.5
#8	0.039 - 0.055	0.88	30.1
#10	0.041 - 0.058	0.88	43.7
1/4	0.043 - 0.064	1.00	104
5/16	0.047 - 0.070	1.12	215
3/8	0.050 - 0.076	1.25	382
7/16	0.063 - 0.092	1.38	611
1/2	0.087 - 0.119	1.50	931
5/8	0.096 - 0.135	1.75	1722
3/4	0.105 - 0.150	2.00	3054
7/8	0.118 - 0.165	2.25	4928
1"	0.130 - 0.181	2.50	7388
1-1/8	0.140 - 0.196	2.81	10464
1-1/4	0.150 - 0.212	3.12	14766
1-3/8	0.162 - 0.228	3.44	19350
1-1/2	0.173 - 0.243	3.75	25692

## Mechanical Properties

Nom Size D	D > 1/2
Hardness (HRC)	37 - 44
Tensile Strength (psi)	135,000 min
Descarburization and Carburization	E=3/4H1

## Typical Application Fixture

Flat socket head cap screws are designed for use in applications where the head cannot protrude above the mating parts. They are set in countersunk holes and the top of the head is flush with the surface of the assembly.

